

SCHEDULE 1

SPECIFICATION OF TREES

Trees specified individually
(encircled in black on the map)

<u>No.on Map</u>	<u>Description</u>	<u>Situation</u>
T1	Sycamore	On land off the A64 York Road Leeds
T2	Oak	do
T3	Thorn	do
T4	Sycamore	do
T5	Ash	do
T6	Plum	do
T7	Ash	do
T8	Ash	do
T9	Sycamore	do
T10	Sycamore	do
T11	Sycamore	do
T12	Oak	do
T13	Oak	do
T14	Sycamore	do
T15	Sycamore	do
T16	Birch	do
T17	Thorn	do
T18	Thorn	do
T19	Ash	do
T20	Thorn	do

<u>No.on Map</u>	<u>Description</u>	<u>Situation</u>
T21	Thorn	On land off the A64 York Road Leeds
T22	Thorn	do
T23	Thorn	do
T24	Thorn	do
T25	Ash	do
T26	Ash	do
T27	Ash	do
T28	Ash	do
T29	Ash	do
T30	Ash	do
T31	Sycamore	do
T32	Ash	do
T33	Sycamore	do
T34	Apple	do
T35	Spruce	do
T36	Beech	do
T37	Willow	do
T38	Beech	do
T39	Ash	do
T40	Cedar	do
T41	Willow	do
T42	Beech	do
T43	Beech	do
T44	Oak	do

<u>No. on map</u>	<u>Description</u>	<u>Situation</u>
T45	Oak	On land off the A64 York Road Leeds
T46	Ash	do
T47	Ash	do
T48	Oak	do
T49	Lime	do
T50	Ash	do
T51	Ash	do
T52	Thorn	do
T53	Thorn	do
T54	Thorn	do
T55	Thorn	do
T56	Thorn	do
T57	Thorn	do
T58	Thorn	do
T59	Thorn	do
T60	Thorn	do
T61	Thorn	do

Trees specified by reference to an area
(within a dotted black line on the map)

NONE

Groups of trees
(within a broken black line on the map)

<u>No.on Map</u>	<u>Description</u>	<u>Situation</u>
G1	Group consisting of 4 Sycamore & 3 Ash	On land off the A64 York Road Leeds
G2	Group consisting of 2 Ash	do
G3	Group consisting of 6 Sycamore, 24 Thorn, 1 Beech & 1 Ash	do
G4	Group consisting of 3 Thorn & 1 Ash	do
G5	Group consisting of 3 Holly	do
G6	Group consisting of 2 Thorn	do

Woodlands
(within a continuous black line on the map)

NONE

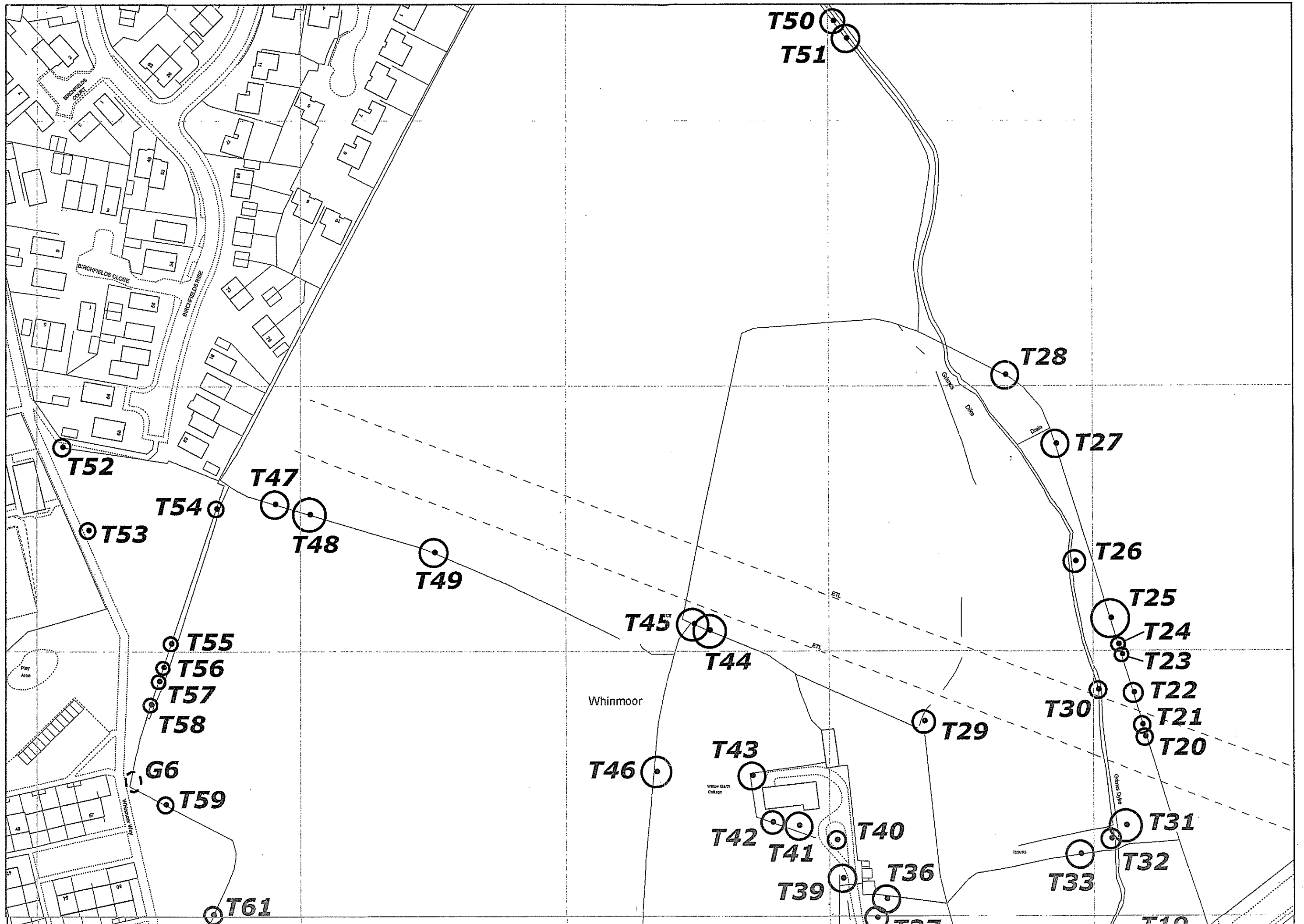

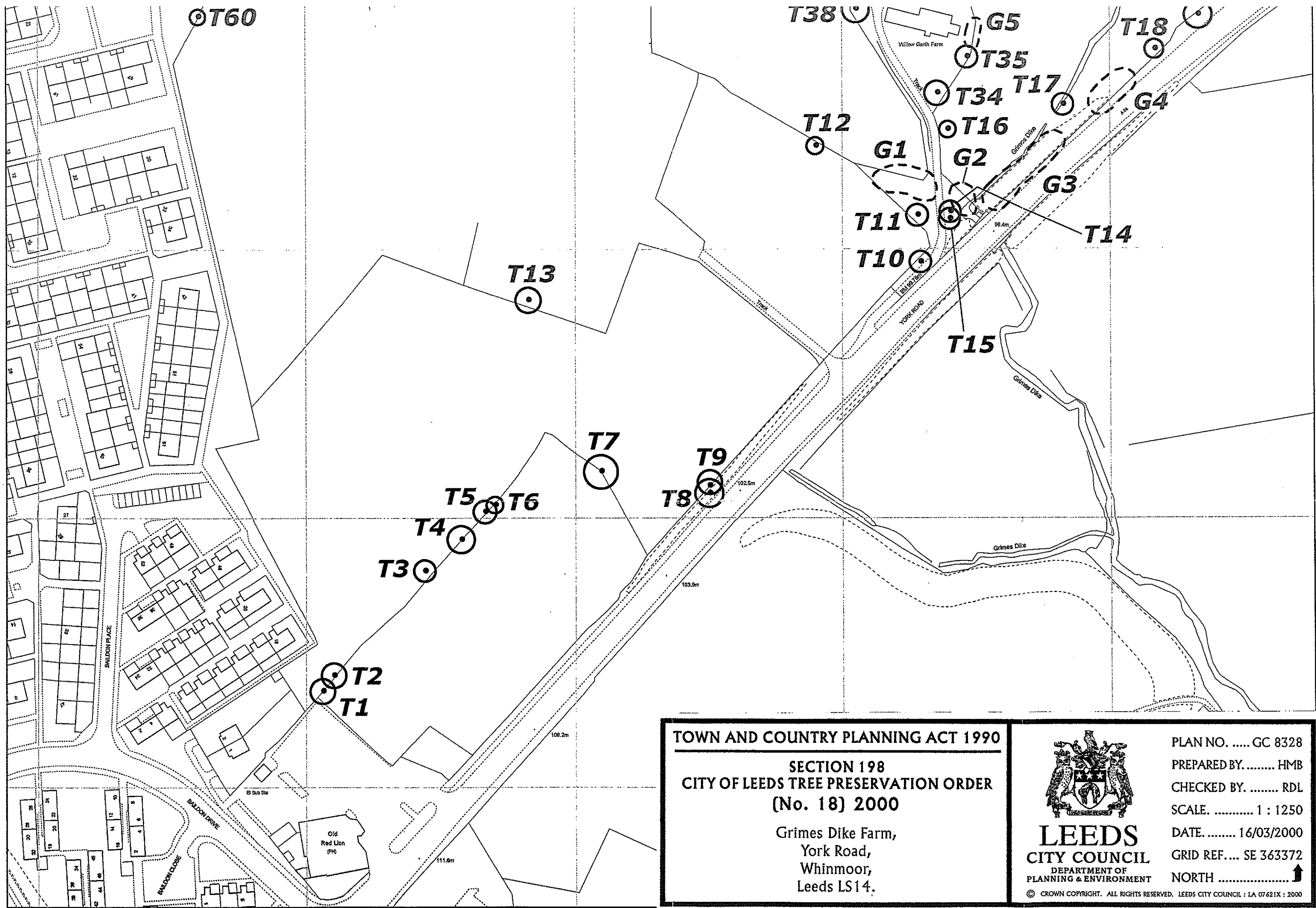

TOWN AND COUNTRY PLANNING ACT 1990

SECTION 198
CITY OF LEEDS TREE PRESERVATION ORDER
(No. 18) 2000

Grimes Dike Farm,
 York Road,
 Whinmoor,
 Leeds LS14.



LEEDS
CITY COUNCIL
 DEPARTMENT OF
 PLANNING & ENVIRONMENT

PLAN NO. GC 8328
 PREPARED BY..... HMB
 CHECKED BY..... RDL
 SCALE..... 1 : 1250
 DATE..... 16/03/2000
 GRID REF.... SE 363372
 NORTH ↑

© CROWN COPYRIGHT. ALL RIGHTS RESERVED. LEEDS CITY COUNCIL : LA 07621X : 2000