

TOWN AND COUNTRY PLANNING ACT 1990

CITY OF LEEDS TREE PRESERVATION ORDER (NO.17) 2012 (LAND AT CRANMER GARDENS LEEDS 17)

Leeds City Council, in exercise of the powers conferred on them by section 198 of the Town and Country Planning Act 1990 make the following Order—

Citation

1. This Order may be cited as City of Leeds Tree Preservation Order (No.18) 2012

Interpretation

2. (1) In this Order “the authority” means the Leeds City Council
- (2) In this Order any reference to a numbered section is a reference to the section so numbered in the Town and Country Planning Act 1990 and any reference to a numbered regulation is a reference to the regulation so numbered in the Town and Country Planning (Tree Preservation)(England) Regulations 2012

Effect

3. (1) Subject to article 4, this Order takes effect provisionally on the date on which it is made.
- (2) Without prejudice to subsection (7) of section 198 (power to make tree preservation orders) or subsection (1) of section 200 (tree preservation orders: Forestry Commissioners) and, subject to the exceptions in regulation 14, no person shall—
 - (a) cut down, top, lop, uproot, wilfully damage, or wilfully destroy; or
 - (b) cause or permit the cutting down, topping, lopping, wilful damage or wilful destruction of,any tree specified in the Schedule to this Order except with the written consent of the authority in accordance with regulations 16 and 17, or of the Secretary of State in accordance with regulation 23, and, where such consent is given subject to conditions, in accordance with those conditions.

Application to trees to be planted pursuant to a condition

4. In relation to any tree identified in the first column of the Schedule by the letter "C", being a tree to be planted pursuant to a condition imposed under paragraph (a) of section 197 (planning permission to include appropriate provision for preservation and planting of trees), this Order takes effect as from the time when the tree is planted.

Dated this 4 day of May 2012

THE COMMON SEAL of
LEEDS CITY COUNCIL was
hereby affixed to this Order
in the presence of:

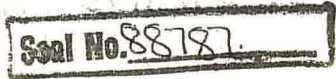

Name: Robert Pritchard

Signature: *Robert Pritchard*
CONFIRMATION OF ORDER

~~Job Title: Section Head (Development)~~
This Order was confirmed by the Leeds City Council without modification on
the 11th day of July 2012

Name: Robert Pritchard

Signature: *Robert Pritchard*

Job Title: Section Head (Development)

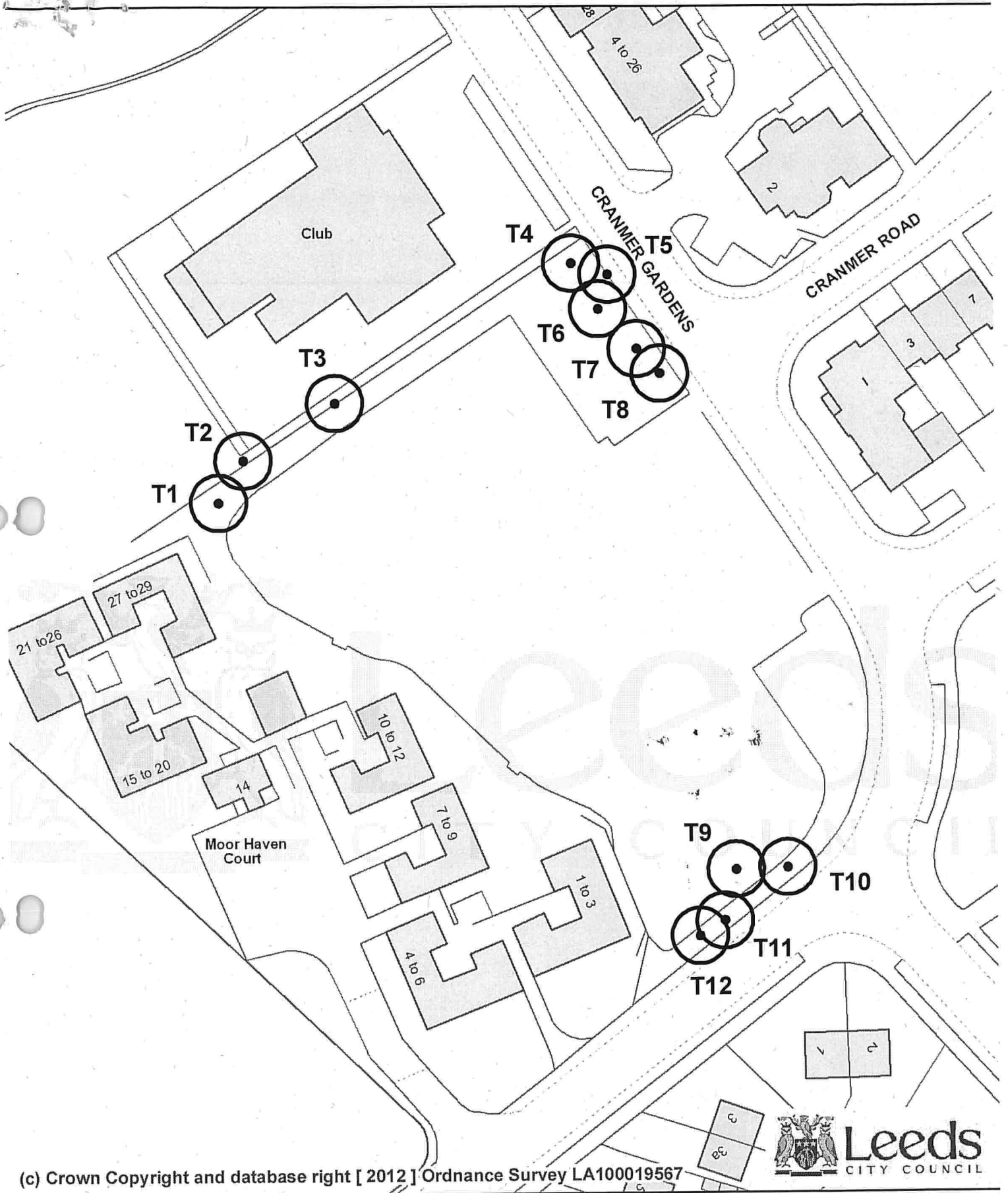

(c) Crown Copyright and database right [2012] Ordnance Survey LA100019567



PRODUCED BY LEEDS CITY COUNCIL

**TOWN AND COUNTRY PLANNING ACT 1990
SECTION 198**

**CITY OF LEEDS TREE PRESERVATION ORDER
(No.17) 2012**

Land adjacent to
Moortown Social Club (former Moorhaven)
Cranmer Gardens LS17 5LA

Plan No..... GIS 5507
Prepared By..... WLM
Checked By..... RD
Scale..... 1/ 750
Date..... 20.04.2012
O.S. Grid Reference.... SE 2939SW
North.....

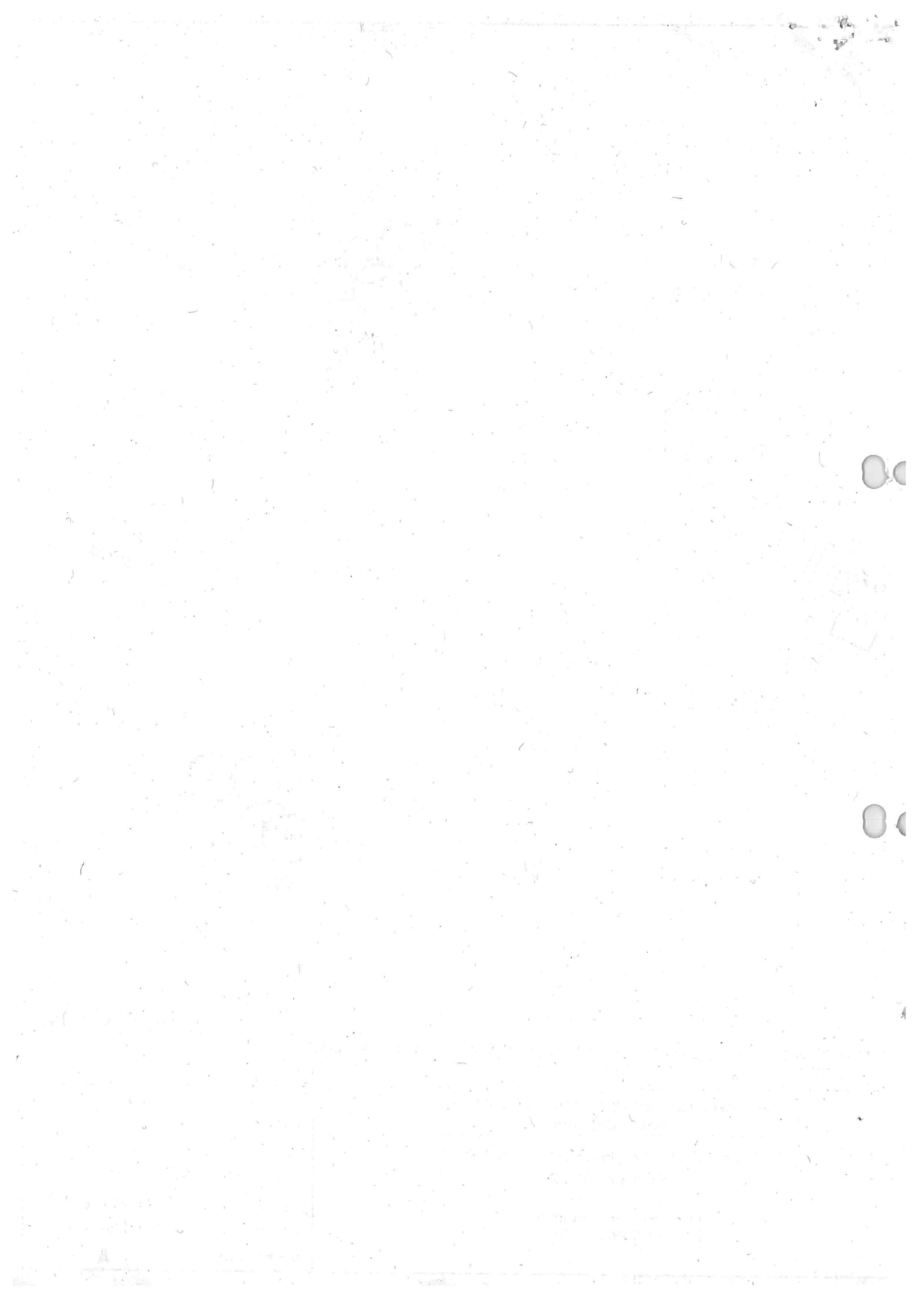

Kob Dracup.

DEVELOPMENT DEPA.		
To	Action	Info

10 AUG 2012

File Number:

SCHEDULE

SPECIFICATION OF TREES

Trees specified individually
(encircled in black on the map)

Reference on map	Description	Situation
T1	Whitebeam	Within the grounds of land at Cranmer Gardens Leeds 17
T2	Beech	as above
T3	Sycamore	as above
T4	Whitebeam	as above
T5	Whitebeam	as above
T6	Whitebeam	as above
T7	Cherry	as above
T8	Cherry	as above
T9	Cherry	as above
T10	Whitebeam	as above
T11	Birch	as above
T12	Whitebeam	as above

Trees specified by reference to an area
(within a dotted black line on the map)

NONE

Groups of trees
(within a broken black line on the map)

NONE

Woodlands
(within a continuous black line on the map)

NONE

