

TOWN AND COUNTRY PLANNING ACT 1990

CITY OF LEEDS TREE PRESERVATION ORDER (NO.25) 2013 (‘THE LODGE’ LIDGETT LANE GLEDHOW LS17)

Leeds City Council, in exercise of the powers conferred on them by section 198 of the Town and Country Planning Act 1990 make the following Order—

Citation

1. This Order may be cited as City of Leeds Tree Preservation Order (No.25) 2013

Interpretation

2. (1) In this Order “the authority” means the Leeds City Council
- (2) In this Order any reference to a numbered section is a reference to the section so numbered in the Town and Country Planning Act 1990 and any reference to a numbered regulation is a reference to the regulation so numbered in the Town and Country Planning (Tree Preservation) (England) Regulations 2012.

Effect

3. (1) Subject to article 4, this Order takes effect provisionally on the date on which it is made.
- (2) Without prejudice to subsection (7) of section 198 (power to make tree preservation orders) or subsection (1) of section 200 (tree preservation orders: Forestry Commissioners) and, subject to the exceptions in regulation 14, no person shall—
 - (a) cut down, top, lop, uproot, wilfully damage, or wilfully destroy; or
 - (b) cause or permit the cutting down, topping, lopping, wilful damage or wilful destruction of,any tree specified in the Schedule to this Order except with the written consent of the authority in accordance with regulations 16 and 17, or of the Secretary of State in accordance with regulation 23, and, where such consent is given subject to conditions, in accordance with those conditions.

Application to trees to be planted pursuant to a condition

4. In relation to any tree identified in the first column of the Schedule by the letter "C", being a tree to be planted pursuant to a condition imposed under paragraph (a) of section 197 (planning permission to include appropriate provision for preservation and planting of trees), this Order takes effect as from the time when the tree is planted.

Dated this 10 day of October 2013

THE COMMON SEAL of
LEEDS CITY COUNCIL was
hereby affixed to this Order
in the presence of:



Name: Helen Atkinson

Signature: *Helen Atkinson*

Job Title: Principal Legal Officer (Development)

Seal No. 90258

CONFIRMATION OF ORDER

This Order was confirmed
without modification by
LEEDS CITY COUNCIL
on the day of November 2013

Name: HELEN ATKINSON

Signature: *Helen Atkinson*

Job Title: PRINCIPAL LEGAL OFFICER, DEVELOPMENT

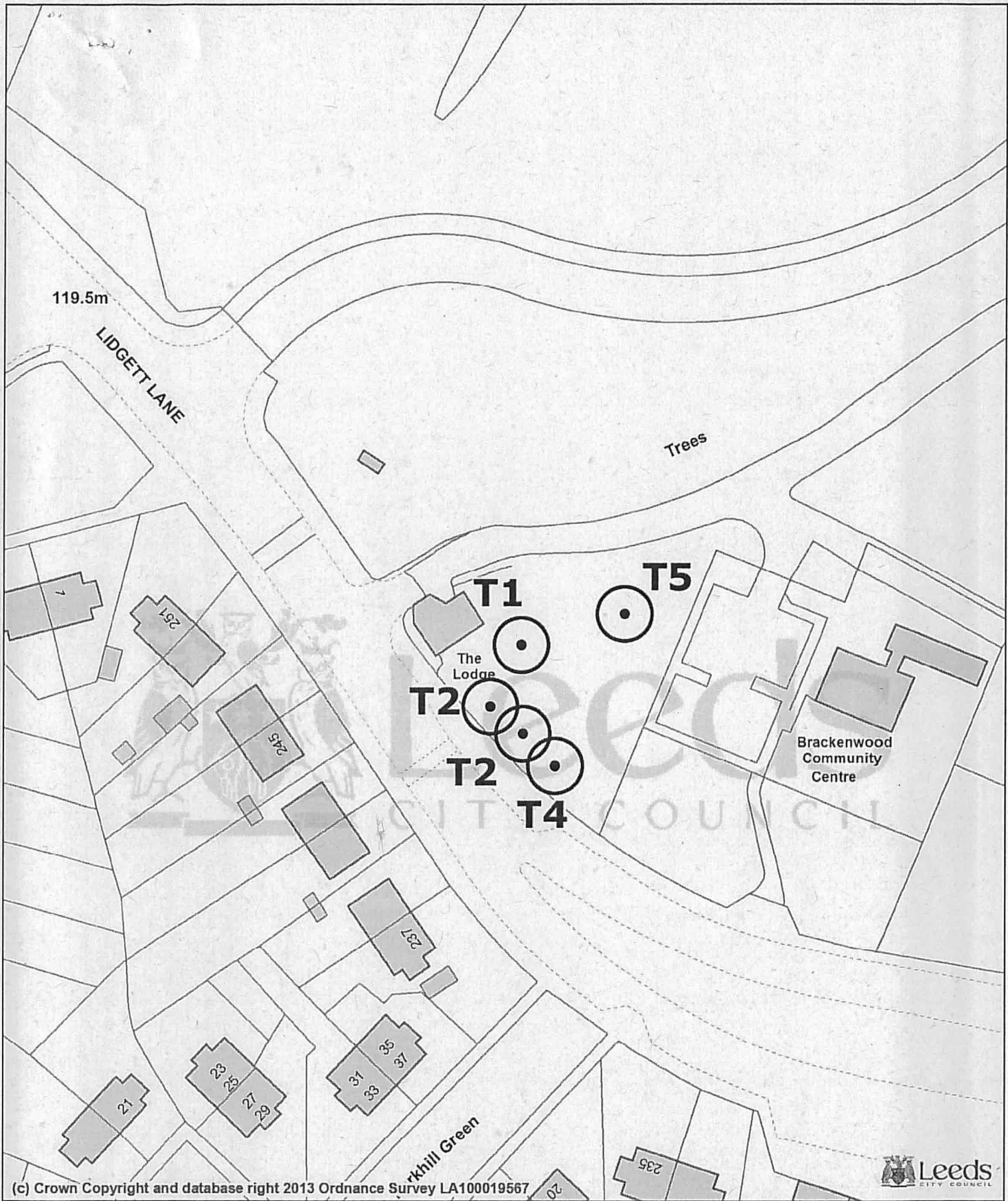

**TOWN AND COUNTRY PLANNING ACT 1990
SECTION 198**

CITY OF LEEDS TREE PRESERVATION ORDER

(No.25) 2013

The Lodge
Lidgett Lane
Gledhow
Leeds
LS17 6QR

Prepared By..... AMW
Checked By..... RD
Scale..... 1/750
Date..... 09.10.2013
O.S. Grid Reference.... SE 3237
North..... 

PRODUCED BY LEEDS CITY COUNCIL

100

100

100

SCHEDULE

SPECIFICATION OF TREES

Trees specified individually
(encircled in black on the map)

Reference on map	Description	Situation
T1	Sycamore	In the grounds of 'The Lodge' Lidgett Lane Leeds 17
T2	Sycamore	In the grounds of 'The Lodge' Lidgett Lane Leeds 17
T3	Sycamore	In the grounds of 'The Lodge' Lidgett Lane Leeds 17
T4	Sycamore	In the grounds of 'The Lodge' Lidgett Lane Leeds 17
T5	Lime	In the grounds of 'The Lodge' Lidgett Lane Leeds 17

Trees specified by reference to an area
(within a dotted black line on the map)

NONE

Groups of trees
(within a broken black line on the map)

NONE

Woodlands
(within a continuous black line on the map)

NONE

SCHEDULE

SPECIFICATION OF TREES

These schedules are to be read in conjunction with the provisions of the Act.

Section 10. (1) The following trees shall be deemed to be trees of the specified class for the purposes of this Act.

No.	Name of tree	Height	Age
1.
2.
3.
4.
5.
6.
7.
8.
9.
10.
11.
12.
13.
14.
15.
16.
17.
18.
19.
20.
21.
22.
23.
24.
25.
26.
27.
28.
29.
30.
31.
32.
33.
34.
35.
36.
37.
38.
39.
40.
41.
42.
43.
44.
45.
46.
47.
48.
49.
50.
51.
52.
53.
54.
55.
56.
57.
58.
59.
60.
61.
62.
63.
64.
65.
66.
67.
68.
69.
70.
71.
72.
73.
74.
75.
76.
77.
78.
79.
80.
81.
82.
83.
84.
85.
86.
87.
88.
89.
90.
91.
92.
93.
94.
95.
96.
97.
98.
99.
100.