

## TOWN AND COUNTRY PLANNING ACT 1990

### CITY OF LEEDS TREE PRESERVATION ORDER (NO.6) 2017 (82 BRADFORD ROAD, OTLEY LEEDS LS21 3LE)

Leeds City Council, in exercise of the powers conferred on them by section 198 of the Town and Country Planning Act 1990 make the following Order—

#### Citation

1. This Order may be cited as City of Leeds Tree Preservation Order (No.6) 2017

#### Interpretation

2. (1) In this Order “the authority” means the Leeds City Council
- (2) In this Order any reference to a numbered section is a reference to the section so numbered in the Town and Country Planning Act 1990 and any reference to a numbered regulation is a reference to the regulation so numbered in the Town and Country Planning (Tree Preservation) (England) Regulations 2012.

#### Effect

3. (1) Subject to article 4, this Order takes effect provisionally on the date on which it is made.
- (2) Without prejudice to subsection (7) of section 198 (power to make tree preservation orders) or subsection (1) of section 200 (tree preservation orders: Forestry Commissioners) and, subject to the exceptions in regulation 14, no person shall—
  - (a) cut down, top, lop, uproot, wilfully damage, or wilfully destroy; or
  - (b) cause or permit the cutting down, topping, lopping, wilful damage or wilful destruction of,any tree specified in the Schedule to this Order except with the written consent of the authority in accordance with regulations 16 and 17, or of the Secretary of State in accordance with regulation 23, and, where such consent is given subject to conditions, in accordance with those conditions.

**Application to trees to be planted pursuant to a condition**

4. In relation to any tree identified in the first column of the Schedule by the letter "C", being a tree to be planted pursuant to a condition imposed under paragraph (a) of section 197 (planning permission to include appropriate provision for preservation and planting of trees), this Order takes effect as from the time when the tree is planted.

Dated this 7 day of March 2017

**THE COMMON SEAL** of  
**LEEDS CITY COUNCIL** was  
hereby affixed to this Order  
in the presence of:

Name: Nikki Deol

Signature:



Job Title: Section Head, Property & Planning

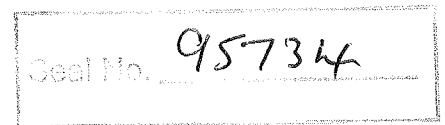

## SCHEDULE

### SPECIFICATION OF TREES

**Trees specified individually**  
(encircled in black on the map)

| <b>Reference on map</b> | <b>Description</b> | <b>Situation</b>                                     |
|-------------------------|--------------------|--|
| T1                      | Large Leaved Lime  | On land at 82 Bradford Road, Otley Leeds LS21<br>3LE |
| T2                      | Cherry             | On land at 82 Bradford Road, Otley Leeds LS21<br>3LE |
| T3                      | Beech              | On land at 82 Bradford Road, Otley Leeds LS21<br>3LE |
| T4                      | Holly              | On land at 82 Bradford Road, Otley Leeds LS21<br>3LE |
| T5                      | Holly              | On land at 82 Bradford Road, Otley Leeds LS21<br>3LE |
| T6                      | Cedar              | On land at 82 Bradford Road, Otley Leeds LS21<br>3LE |
| T7                      | Spruce             | On land at 82 Bradford Road, Otley Leeds LS21<br>3LE |
| T8                      | ASH                | On land at 82 Bradford Road, Otley Leeds LS21<br>3LE |

**Trees specified by reference to an area**  
(within a dotted black line on the map)

| <b>Reference on map</b> | <b>Description</b>        | <b>Situation</b>                                  |
|-------------------------|---------------------------|---|
| A1                      | Trees of whatever species | On land at 82 Bradford Road, Otley Leeds LS21 3LE |

**Groups of trees**  
(within a broken black line on the map)

**NONE**

| <b>Reference on map</b> | <b>Description</b> | <b>Situation</b> |
|-------------------------|--------------------|------------------|
|                         | <b>NONE</b>        |                  |

**Woodlands**  
(within a continuous black line on the map)

| <b>Reference on map</b> | <b>Description</b>                                   | <b>Situation</b>                                  |
|-------------------------|--|---|
| W1                      | Woodland consisting of mainly of Ash Sycamore Willow | On land at 82 Bradford Road, Otley Leeds LS21 3LE |

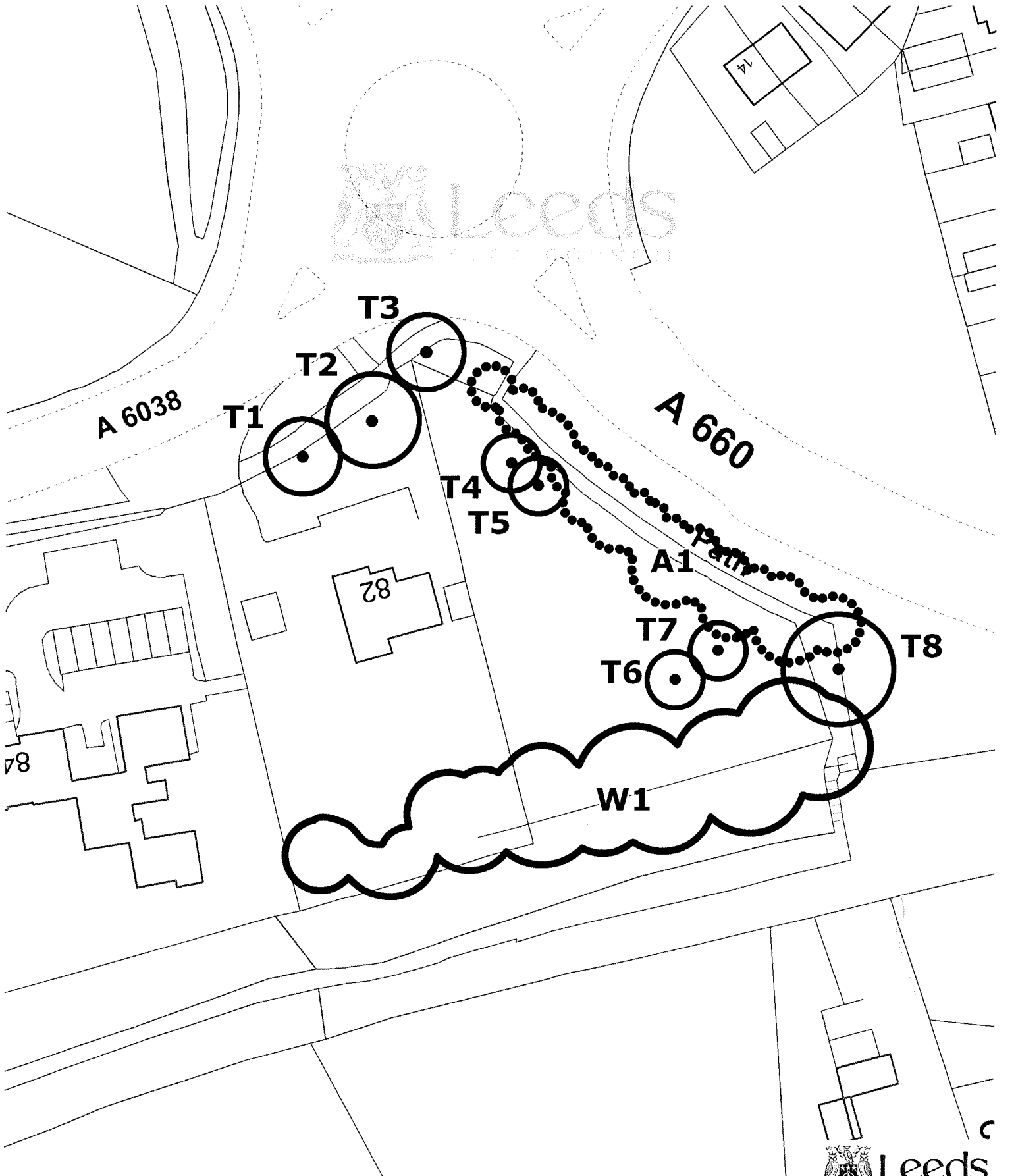

Crown Copyright and database rights 2017 Ordnance Survey 10019567  
 YOU ARE NOT PERMITTED TO COPY, SUB-LICENCE, DISTRIBUTE OR SELL ANY OF THIS DATA TO THIRD PARTIES IN ANY FORM



**TOWN AND COUNTRY PLANNING ACT 1990  
 SECTION 198**

CITY OF LEEDS TREE PRESERVATION ORDER

**(No.06) 2017**

82 Bradford Road  
 Otley  
 LS21 3LE

Prepared By..... NI  
 Checked By..... SC  
 Scale..... 1:700  
 Date..... 27/02/2017  
 O.S. Grid Reference.... SE 1944  
 North.....



PRODUCED BY LEEDS CITY COUNCIL



CITY OF LEEDS TREE PRESERVATION ORDER (NO.6) 2017  
(82 BRADFORD ROAD, OTLEY LEEDS LS21 3LE)

CONFIRMATION OF ORDER

The above named Order was confirmed by the Leeds City Council without modification on the 11 day of July 2017

Name: Sarah Blenkin

Signature: 

Job Title: Commercial Property Team Leader

