

TOWN AND COUNTRY PLANNING ACT 1990

CITY OF LEEDS TREE PRESERVATION ORDER (NO.28) 2018 (LAND TO THE SIDE OF 3 DUNSTARN DRIVE LEEDS 16)

Leeds City Council, in exercise of the powers conferred on them by section 198 of the Town and Country Planning Act 1990 make the following Order—

Citation

1. This Order may be cited as City of Leeds Tree Preservation Order (No.28) 2018

Interpretation

2. (1) In this Order “the authority” means the Leeds City Council
- (2) In this Order any reference to a numbered section is a reference to the section so numbered in the Town and Country Planning Act 1990 and any reference to a numbered regulation is a reference to the regulation so numbered in the Town and Country Planning (Tree Preservation) (England) Regulations 2012.

Effect

3. (1) Subject to article 4, this Order takes effect provisionally on the date on which it is made.
- (2) Without prejudice to subsection (7) of section 198 (power to make tree preservation orders) or subsection (1) of section 200 (tree preservation orders: Forestry Commissioners) and, subject to the exceptions in regulation 14, no person shall—
 - (a) cut down, top, lop, uproot, wilfully damage, or wilfully destroy; or
 - (b) cause or permit the cutting down, topping, lopping, wilful damage or wilful destruction of,any tree specified in the Schedule to this Order except with the written consent of the authority in accordance with regulations 16 and 17, or of the Secretary of State in accordance with regulation 23, and, where such consent is given subject to conditions, in accordance with those conditions.

Application to trees to be planted pursuant to a condition

4. In relation to any tree identified in the first column of the Schedule by the letter "C", being a tree to be planted pursuant to a condition imposed under paragraph (a) of section 197 (planning permission to include appropriate provision for preservation and planting of trees), this Order takes effect as from the time when the tree is planted.

Dated this 20 day of December 2018

THE COMMON SEAL of
LEEDS CITY COUNCIL was
hereby affixed to this Order
in the presence of:

Name: PHILIPPA PLUMTREE-VARLEY

Signature: 

Job Title: PRINCIPAL LEGAL OFFICER
DEVELOPMENT TEAM LEADER

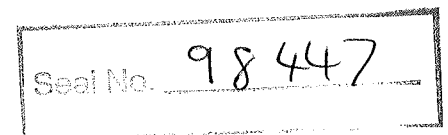

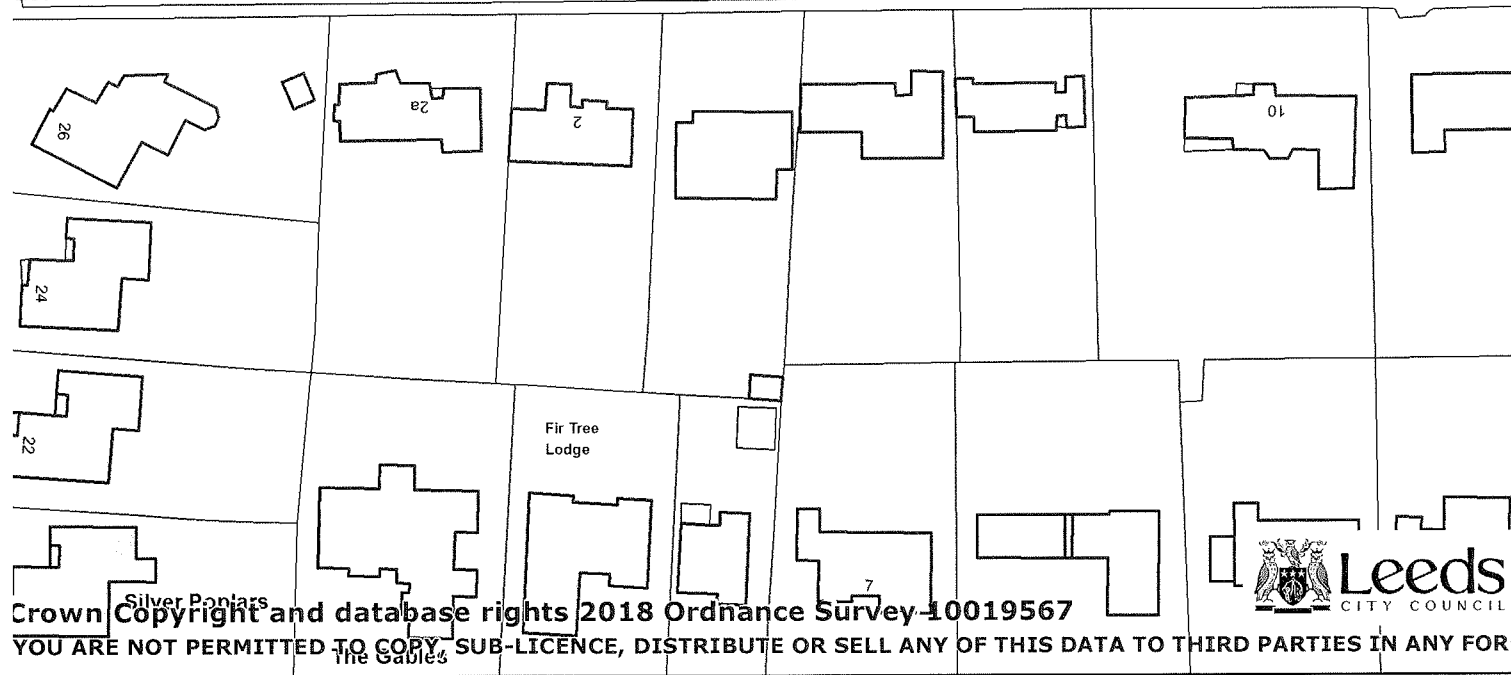
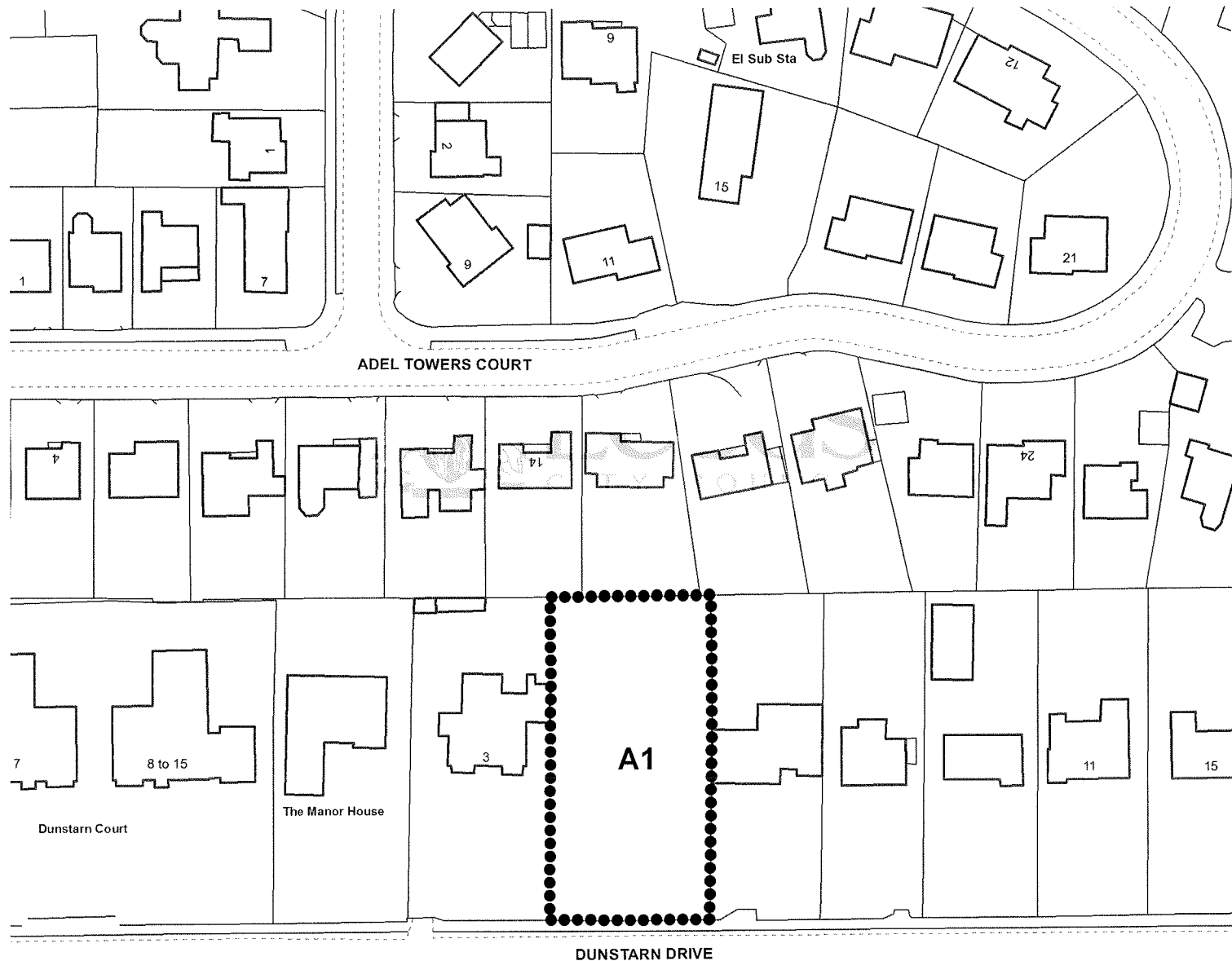

Crown Copyright and database rights 2018 Ordnance Survey 10019567
 YOU ARE NOT PERMITTED TO COPY, SUB-LICENCE, DISTRIBUTE OR SELL ANY OF THIS DATA TO THIRD PARTIES IN ANY FORM

**TOWN AND COUNTRY PLANNING ACT 1990
 SECTION 198**

**CITY OF LEEDS TREE PRESERVATION ORDER
 (No.28) 2018**
 Land to the side of
 3 Dunstarn Drive
 Leeds
 LS16

Prepared By..... NF
 Checked By..... RL
 Scale..... 1:1000
 Date..... 20/12/2018
 O.S. Grid Reference.... SE 2739
 North..... 
 PRODUCED BY LEEDS CITY COUNCIL

SCHEDULE

SPECIFICATION OF TREES

Trees specified individually
(encircled in black on the map)

NONE

Trees specified by reference to an area
(within a dotted black line on the map)

Reference on map	Description	Situation
A1	All Trees of Whatever Species	On land to the side of 3 Dunstarn Drive, Leeds 16

Groups of trees
(within a broken black line on the map)

NONE

Woodlands
(within a continuous black line on the map)

NONE

**CITY OF LEEDS TREE PRESERVATION ORDER (NO.28) 2018
(LAND TO THE SIDE OF 3 DUNSTARN DRIVE LEEDS 16)**

CONFIRMATION OF ORDER

The above named Order was confirmed by the Leeds City Council without modification on the 14 day of March 2019

Name: *Nikhil Doshi*

Signature: *[Handwritten Signature]*

Job Title: *Section Head - Property & Development*