

TOWN AND COUNTRY PLANNING ACT 1990  
CITY OF LEEDS TREE PRESERVATION ORDER  
(NO.062) 2025

TPO 2025\_062 (144 WAKEFIELD ROAD  
DRIGHLINGTON BRADFORD BD11 1EA)

CONFIRMATION OF ORDER

The above named Order was confirmed by  
Leeds City Council without modification

on the 11 December 2025

Name: *Phillippa Plumtree-Varley*

Signature:

Job Title:

*Phillippa Plumtree-Varley  
Development Team Leader  
Legal Services*



**CITY OF LEEDS TREE PRESERVATION ORDER (NO.062) 2025  
TPO 2025\_062 (144 WAKEFIELD ROAD DRIGHLINGTON BRADFORD BD11  
1EA)**

Leeds City Council, in exercise of the powers conferred on them by section 198 of the Town and Country Planning Act 1990 makes the following Order—

**Citation**

1. This Order may be cited as City of Leeds Tree Preservation Order (No.062) 2025: TPO2025\_062

**Interpretation**

2. (1) In this Order “the authority” means the Leeds City Council
- (2) In this Order any reference to a numbered section is a reference to the section so numbered in the Town and Country Planning Act 1990 and any reference to a numbered regulation is a reference to the regulation so numbered in the Town and Country Planning (Tree Preservation) (England) Regulations 2012.

**Effect**

3. (1) Subject to article 4, this Order takes effect provisionally on the date on which it is made.
- (2) Without prejudice to subsection (7) of section 198 (power to make tree preservation orders) or subsection (1) of section 200 (tree preservation orders: Forestry Commissioners) and, subject to the exceptions in regulation 14, no person shall—
  - (a) cut down, top, lop, uproot, wilfully damage, or wilfully destroy; or
  - (b) cause or permit the cutting down, topping, lopping, wilful damage or wilful destruction of,any tree specified in the Schedule to this Order except with the written consent of the authority in accordance with regulations 16 and 17, or of the Secretary of State in accordance with regulation 23, and, where such consent is given subject to conditions, in accordance with those conditions.

**Application to trees to be planted pursuant to a condition**

4. In relation to any tree identified in the first column of the Schedule by the letter "C", being a tree to be planted pursuant to a condition imposed under paragraph (a) of section 197 (planning permission to include appropriate provision for preservation and planting of trees), this Order takes effect as from the time when the tree is planted.

Dated: 17 June 2025

**THE COMMON SEAL** of  
**LEEDS CITY COUNCIL** was  
hereby affixed to this Order  
in the presence of:

Name:

Signature:



Job Title:

Gregg Shevill  
General Property Team Leader  
Legal Services



Seal No. 10980

## SCHEDULE

### SPECIFICATION OF TREES

**Trees specified individually**  
(encircled in black on the map)

Reference on map	Description	Situation
T1	Sycamore	On land at 144 Wakefield Road
T2	Sycamore	On land at 144 Wakefield Road
T3	Common Lime	On land at 144 Wakefield Road
T4	Sycamore	On land at 144 Wakefield Road
T5	Sycamore	On land at 144 Wakefield Road
T6	Sycamore	On land at 144 Wakefield Road

**Trees specified by reference to an area**  
(within a dotted black line on the map)

NONE

**Groups of trees**  
(within a broken black line on the map)

NONE

**Woodlands**  
(within a continuous black line on the map)

NONE



WAKEFIELD ROAD

185.4m

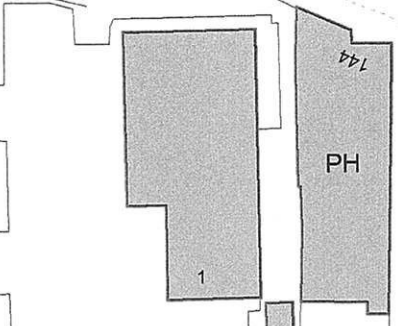

ESS

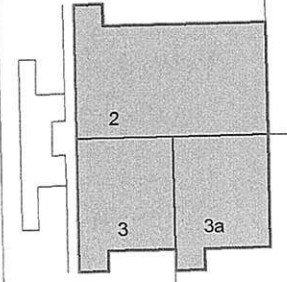

Adwalton  
Business  
Park

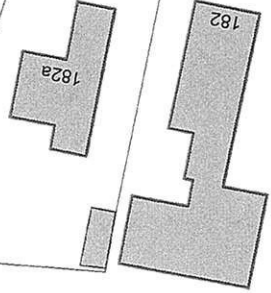
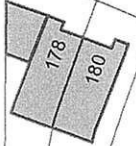
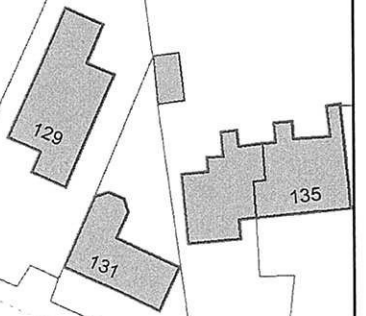
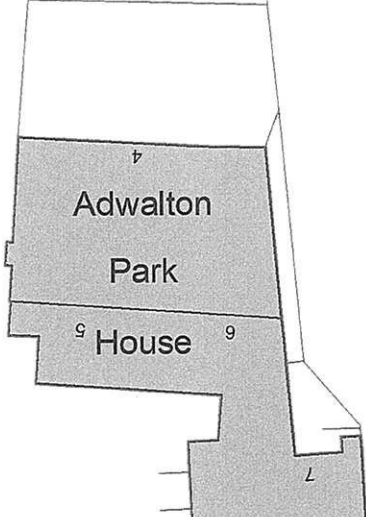
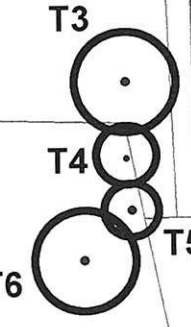
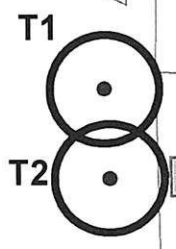

Crown Copyright and database rights 2025 Ordnance Survey AC0000815564  
YOU ARE NOT PERMITTED TO COPY, SUB-LICENCE, DISTRIBUTE OR SELL ANY OF THIS DATA TO THIRD PARTIES IN ANY FORM



**TOWN AND COUNTRY PLANNING ACT 1990  
SECTION 198**

CITY OF LEEDS TREE PRESERVATION ORDER

**(No.062) 2025**

144, Wakefield Road,  
Drighlington,  
Bradford,  
BD11 1EA

Prepared By..... KJW  
Checked By..... SW  
Scale..... 1:750  
Date..... 03/06/2025  
O.S. Grid Reference.... SE2328  
North.....

PRODUCED BY LEEDS CITY COUNCIL

